

# Forward Family

## rackmount panels & cable management

### Hardware free is the way to be.

Stop fussing around with rack screws when installing panels or lacer bars. Installation is up to 5X faster when you simply click the panel or cable management in and move on to more important things.

Compatible on all BGR Series enclosures.

### features:

- No rack screws! Easily install & remove your panels and cable management without any hardware
- 5X faster installation over traditional rack screw installation
- Ergonomic clips for easy installation and removal
- Spring loaded clips secure panel into the Forward rackrail
- Black powder coat finish
- Compatible with Forward rackrail & enclosures



FWD-DIN1H



FWD-EB1



FWD-LB-2A-4PK



FWD-VT1

### specifications:

Forward Family blank panels shall be Middle Atlantic Products model # FWD-\_\_B\_\_ (refer to chart). Forward Family blank panels shall be \_\_ rackspaces in height with a \_\_ finish (refer to chart). Forward Family blank panels shall be 19" wide. Forward Family blank panels shall be compatible with Forward Family rail and shall accommodate tool-free mounting. Forward Family blank panels shall be constructed of flanged steel. Forward Family blank panels shall be RoHS EU Directive 2002/95/EC compliant. Forward Family blank panels shall be manufactured by an ISO 9001 and ISO 14001 registered company. Forward Family blank panels shall be warrantied to be free from defects in material or workmanship under normal use and conditions for the lifetime of the panel.

Forward Family vent panels shall be Middle Atlantic Products model # FWD-VT\_\_ (refer to chart). Forward Family vent panels shall be \_\_ rackspaces in height with a black powdercoat finish (refer to chart). Forward Family vent panels shall provide 74% open area and shall be 19" wide. Forward Family vent panels shall be compatible with Forward Family rail and shall accommodate tool-free mounting.



WHAT GREAT SYSTEMS ARE BUILT ON™ | LEGRANDAV.COM

USA P 800.266.7225 E av.middleatlantic.support@legrand.com  
CANADA P 888.766.9770 E av.middleatlantic.support@legrand.com

©2019 Middle Atlantic Products, Inc. All rights reserved. All other brand names or marks are used for identification purposes and are trademarks of their respective owners. All patents are protected under existing designations. Other patents pending.



COMMERCIAL BRANDS

C2G | Chief | Da-Lite | Luxul | Middle Atlantic | Vaddio | Wiremold

120-00006 / rev - / 8-23-19

# Forward Family

rackmount panels & cable management

## specifications:

Forward Family vent panels shall be constructed of flanged steel. Forward Family vent panels shall be RoHS EU Directive 2002/95/EC compliant. Forward Family vent panels shall be manufactured by an ISO 9001 and ISO 14001 registered company. Forward Family vent panels shall be warrantied to be free from defects in material or workmanship under normal use and conditions for the lifetime of the panel.

Forward Family DIN rail panels shall be Middle Atlantic Products model # FWD-DIN1H. Forward Family DIN rail panels shall be 1 rackspace in height with a black powdercoat finish. Forward Family DIN rail panels shall be 19" wide. Forward Family DIN rail panels shall be compatible with Forward Family rail and shall accommodate tool-free mounting. Forward Family DIN rail panels shall be constructed of flanged steel. Forward Family DIN panels shall be RoHS EU Directive 2002/95/EC compliant. Forward Family DIN panels shall be manufactured by an ISO 9001 and ISO 14001 registered company. Forward Family DIN panels shall be warrantied to be free from defects in material or workmanship under normal use and conditions for the lifetime of the panel.

Forward Family horizontal lacer bars shall be Middle Atlantic Products model # FWD-LB-\_A-4PK (refer to chart) and include 4 pieces. Forward Family horizontal lacer bars shall be 1 rackspace in height with a black powdercoat finish and a \_\_\_" offset (refer to chart). Forward Family horizontal lacer bars shall be 19" wide. Forward Family lacer bars shall be compatible with Forward Family rail and shall accommodate tool-free mounting. Forward Family lacer bars shall be constructed of steel. Forward Family lacer bars shall be RoHS EU Directive 2002/95/EC compliant. Forward Family lacer bars shall be manufactured by an ISO 9001 and ISO 14001 registered company. Forward Family lacer bars shall be warrantied to be free from defects in material or workmanship under normal use and conditions for the lifetime of the product.

Customizable specification clips available at [middleatlantic.com](http://middleatlantic.com)



WHAT GREAT SYSTEMS ARE BUILT ON™ | [LEGRANDAV.COM](http://LEGRANDAV.COM)

USA P 800.266.7225 E [av.middleatlantic.support@legrand.com](mailto:av.middleatlantic.support@legrand.com)  
CANADA P 888.766.9770 E [av.middleatlantic.support@legrand.com](mailto:av.middleatlantic.support@legrand.com)

©2019 Middle Atlantic Products, Inc. All rights reserved. All other brand names or marks are used for identification purposes and are trademarks of their respective owners. All patents are protected under existing designations. Other patents pending.



COMMERCIAL BRANDS

C2G | Chief | Da-Lite | Luxul | Middle Atlantic | Vaddio | Wiremold

120-00006 / rev - / 8-23-19

# Forward Family

## rackmount panels & cable management basic dimensions

NOTE(S):  
 1. ALL DIMENSIONS SHOWN IN FORMAT:  
 INCHES [MILLIMETERS]  
 2. COMPATIBLE WITH FORWARD RACKRAIL  
 3. FWD-EB1 SHOWN

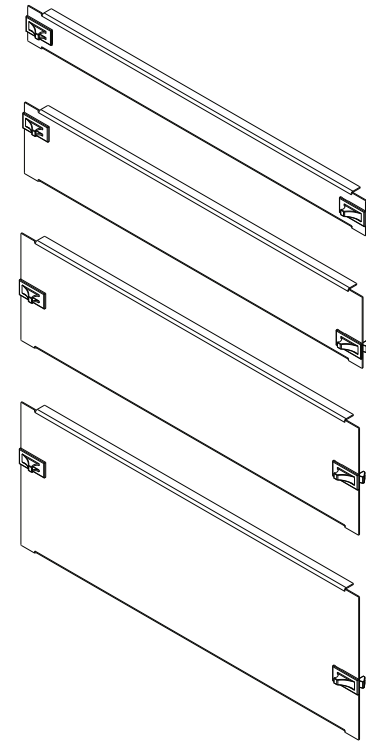
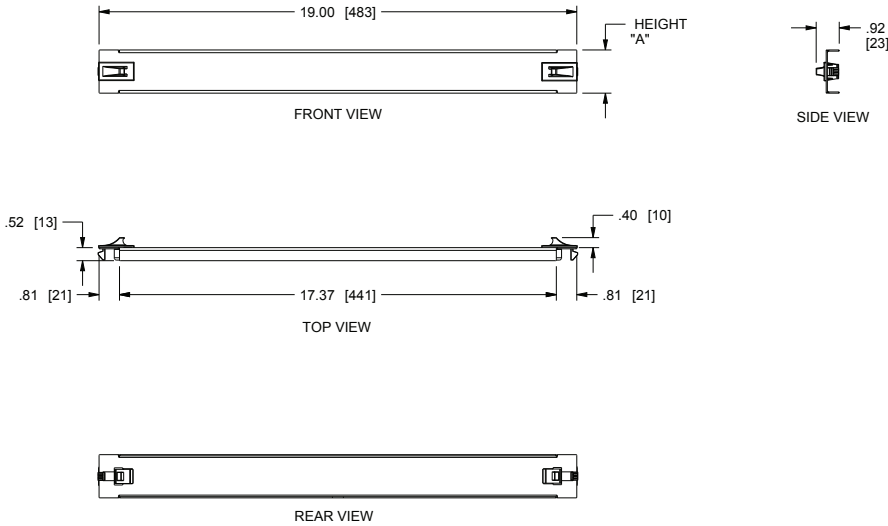

SKU #	HEIGHT "A"	RACK UNITS	FINISH
FWD-EB1	1.72 [44]	1 RU	FLAT BLACK
FWD-EB2	3.47 [88]	2 RU	FLAT BLACK
FWD-EB3	5.22 [133]	3 RU	FLAT BLACK
FWD-EB4	6.97 [177]	4 RU	FLAT BLACK
FWD-SB1	1.72 [44]	1 RU	TEXTURED BLACK
FWD-SB2	3.47 [88]	2 RU	TEXTURED BLACK
FWD-SB3	5.22 [133]	3 RU	TEXTURED BLACK
FWD-SB4	6.97 [177]	4 RU	TEXTURED BLACK



WHAT GREAT SYSTEMS ARE BUILT ON™ | LEGRANDAV.COM

USA P 800.266.7225 E av.middleatlantic.support@legrand.com  
 CANADA P 888.766.9770 E av.middleatlantic.support@legrand.com

©2019 Middle Atlantic Products, Inc. All rights reserved. All other brand names or marks are used for identification purposes and are trademarks of their respective owners. All patents are protected under existing designations. Other patents pending.



COMMERCIAL BRANDS

C2G | Chief | Da-Lite | Luxul | Middle Atlantic | Vaddio | Wiremold

# Forward Family

## rackmount panels & cable management basic dimensions

- NOTE(S):
1. ALL DIMENSIONS SHOWN IN FORMAT:  
INCHES [MILLIMETERS]
  2. COMPATIBLE WITH FORWARD RACKRAIL
  3. PERFORATED OPEN AREA - 74%
  4. FWD-VT1 SHOWN

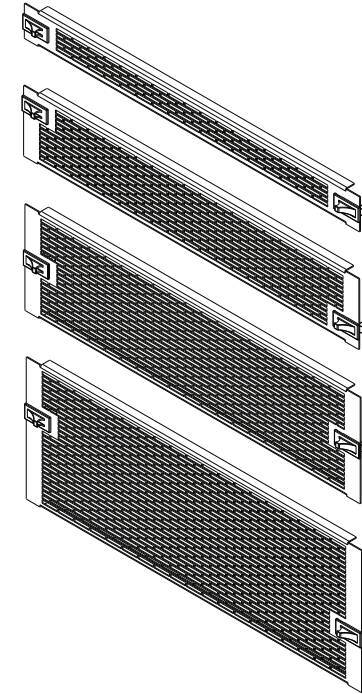
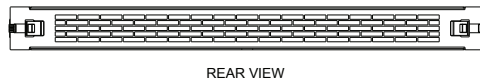
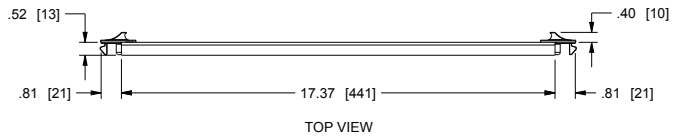
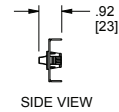
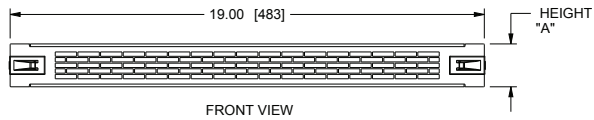

SKU #	HEIGHT "A"	RACK UNITS
FWD-VT1	1.72 [44]	1 RU
FWD-VT2	3.47 [88]	2 RU
FWD-VT3	5.22 [133]	3 RU
FWD-VT4	6.97 [177]	4 RU



WHAT GREAT SYSTEMS ARE BUILT ON™ | [LEGRANDAV.COM](http://LEGRANDAV.COM)

USA P 800.266.7225 E [av.middleatlantic.support@legrand.com](mailto:av.middleatlantic.support@legrand.com)  
 CANADA P 888.766.9770 E [av.middleatlantic.support@legrand.com](mailto:av.middleatlantic.support@legrand.com)

©2019 Middle Atlantic Products, Inc. All rights reserved. All other brand names or marks are used for identification purposes and are trademarks of their respective owners. All patents are protected under existing designations. Other patents pending.



COMMERCIAL BRANDS

C2G | Chief | Da-Lite | Luxul | Middle Atlantic | Vaddio | Wiremold

# Forward Family

## rackmount panels & cable management basic dimensions

- NOTE(S):  
 1. ALL DIMENSIONS SHOWN IN FORMAT:  
 INCHES [MILLIMETERS]  
 2. COMPATIBLE WITH FORWARD RACKRAIL  
 3. FWD-DIN1H SHOWN

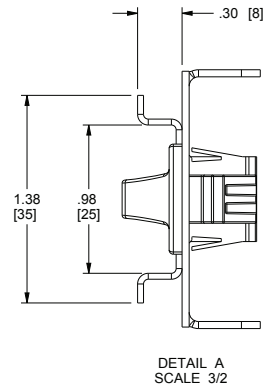
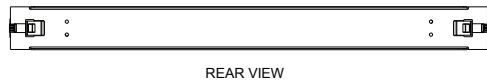
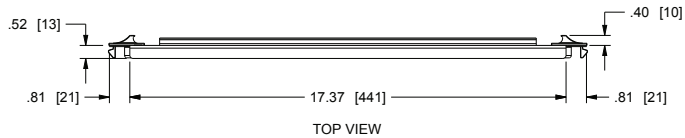
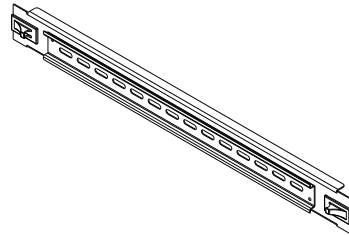
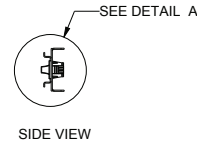
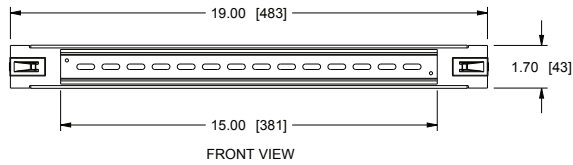

WHAT GREAT SYSTEMS ARE BUILT ON™ | LEGRANDAV.COM

USA P 800.266.7225 E av.middleatlantic.support@legrand.com  
 CANADA P 888.766.9770 E av.middleatlantic.support@legrand.com

©2019 Middle Atlantic Products, Inc. All rights reserved. All other brand names or marks are used for identification purposes and are trademarks of their respective owners. All patents are protected under existing designations. Other patents pending.



COMMERCIAL BRANDS

C2G | Chief | Da-Lite | Luxul | Middle Atlantic | Vaddio | Wiremold

# Forward Series

## rackmount panels & cable management basic dimensions

- NOTE(S):  
 1. ALL DIMENSIONS SHOWN IN FORMAT:  
 INCHES [MILLIMETERS]  
 2. COMPATIBLE WITH FORWARD RACKRAIL  
 3. FWD-LB-2A-4PK SHOWN

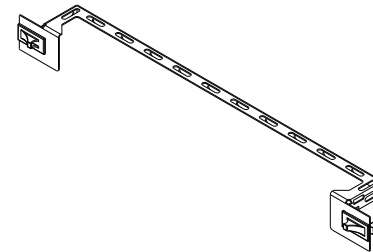
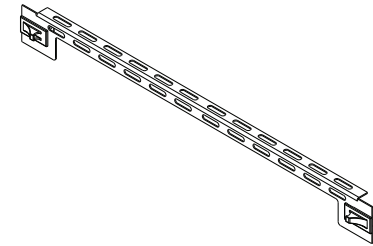
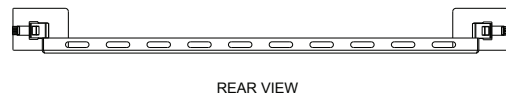
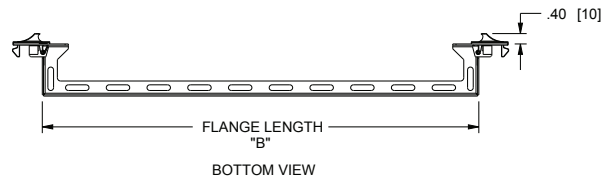
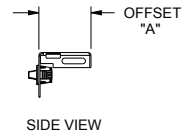
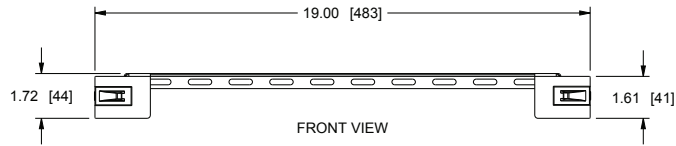

SKU #	OFFSET "A"	FLANGE LENGTH "B"	RACK UNITS
FWD-LB-1A-4PK	0.58 [15]	17.37 [441]	1 RU
FWD-LB-2A-4PK	2.00 [51]	16.75 [425]	1 RU



WHAT GREAT SYSTEMS ARE BUILT ON™ | [LEGRANDAV.COM](http://LEGRANDAV.COM)

USA P 800.266.7225 E [av.middleatlantic.support@legrand.com](mailto:av.middleatlantic.support@legrand.com)  
 CANADA P 888.766.9770 E [av.middleatlantic.support@legrand.com](mailto:av.middleatlantic.support@legrand.com)

©2019 Middle Atlantic Products, Inc. All rights reserved. All other brand names or marks are used for identification purposes and are trademarks of their respective owners. All patents are protected under existing designations. Other patents pending.



COMMERCIAL BRANDS

C2G | Chief | Da-Lite | Luxul | Middle Atlantic | Vaddio | Wiremold